

Stud Nuts & Kits

Studkits for ISO 03, ISO 05, ISO 07, and ISO 08 Modules

To simplify the installation of ISO 03, ISO 05, ISO 07, and ISO 08 sandwiches, Lynch offers uncut (can be cut to length in the field) or precut studkits in both inch and metric standard threaded rod. Once the rods are installed in a subplate or manifold, they act as a guide in assembling the sandwich body stack. After the directional control valve is assembled on top of a stack, Lynch studnuts are used to retain the assembled stack.

The inch and metric studrods are both made of high tensile, fully threaded ASTM-A-193 Grade B material with the following mechanical properties:

- 125,000 psi minimum tensile strength.
- 105,000 psi minimum yield point.
- 26 32 Rc hardness.

The studnuts are special hex socket nuts with the following features:

- An outside diameter equivalent to a standard socket head cap screw.
- Full thread engagement as shown.
- Mechanical stop between the internal hex and the thread to prevent the hex wrench from being pushed out of its socket.

STUD NUTS

ISO 03

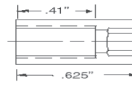

P/N 350 005 : 10-24 UNC Stud nut
5/32" Internal Hex Size

P/N 350 009 : M5x0.80 Stud nut
4 mm Internal Hex Size

ISO 05 & 07

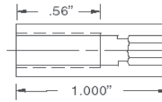

P/N 350 004 : 1/4"-20 UNC Stud nut
3/16" Internal Hex Size

P/N 350 008 : M6x1.00 Stud nut
5 mm Internal Hex Size

ISO 07

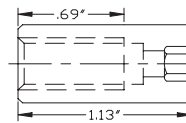

P/N 2000F03-02662 : 3/8"-16 UNC Stud nut
5/16" Internal Hex Size

P/N 2000F03-02663 : M10x1.50 Stud nut
8 mm Internal Hex Size

ISO 08

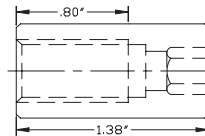

P/N 95F03-1256 : 1/2"-13 UNC Stud nut
3/8" Internal Hex Size

P/N 2000F03-02664 : M12x1.75 Stud nut
10 mm Internal Hex Size

STUDROD LENGTH DETERMINATION CHART

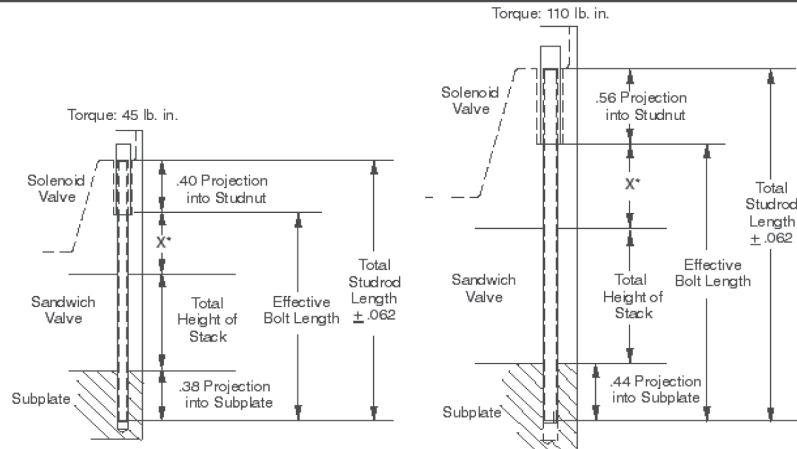

	ISO 03		ISO 05 and ISO 07 X,Y	
	Model	"X" inches*	Model	"X" inches*
Continental	EB03M	.625	VS12M	1.31
Continental	VS5M	.625	ED05M	1.31
Double A (Vickers)	Q*-3	1.56	Q*-5	1.05
Parker-Hannifin	D1VW	1.50	D3W	1.91
Racine Bosch	.25NG6	.87	1/4"	1.38
Rexroth	4WRA6	1.26	4WE10, 4WEH10	1.18
Dynex/Rivett	6500 Series 03	.44	6500-02	.38
Vickers/40	DG4V	1.56	DG4S4	1.05
Vickers/60	DG4V	.83	DG4V5	1.18
Nachi 1	SSG01	1.44	SSG03,E10,E20	2.38

* The X dimension was accurate as of the publication date of this catalog. Verify in the applicable manufacturers literature.

WE RESERVE THE RIGHT TO DISCONTINUE MODELS, OR CHANGE SPECIFICATIONS WITHOUT NOTICE OR INCURRING OBLIGATION

Lynch Products Can Be Modified to Suit Your Application